



GOODMAN KWAI CHUNG LOGISTICS CENTRE

嘉民葵涌物流中心

Affordable warehouse facility in premium location
優越地段 實用空間

KEY PROPERTY FEATURES:

Sub-divisible floor plates
每層可靈活分間單位

Functional loading and unloading spaces over two levels
設有貨物起卸台於兩樓層供貨車使用

Six cargo lifts and two passenger lifts
共6部載貨升降機及2部客用升降機

Close to Tai Wo Hau station
鄰近港鐵大窩口站



11 MIN

walk to Tai Wo Hau MTR
步行至大窩口港鐵站



21 MIN

drive to HK International Airport
行車至香港國際機場



9 MIN

drive to Container Terminal
行車至貨櫃碼頭



33 MIN

drive to Man Kam To
行車至文錦渡



MAKING SPACE FOR GREATNESS

KWAI CHUNG 葵涌
585-609 CASTLE PEAK ROAD
青山公路585-609號

PLANS

規劃

397,100 SQ FT

平方呎

Total Gross Area (sq ft)
總建築面積 (平方呎)

Floor plate (sq ft) 25,469-26,050
每層樓面面積 (平方呎)

Ceiling height (ft/m) 11-12 / 3.35-3.65
樓高 (呎/米)

Floor loading capacity (lbs/sq ft) 150-250
樓面負重量 (磅 / 平方呎)

No. of cargo lifts 6
載貨升降機

Cargo lift loading capacity (kg) 2,050
載貨升降機負重量 (公斤)

Typical floor plan 平面圖

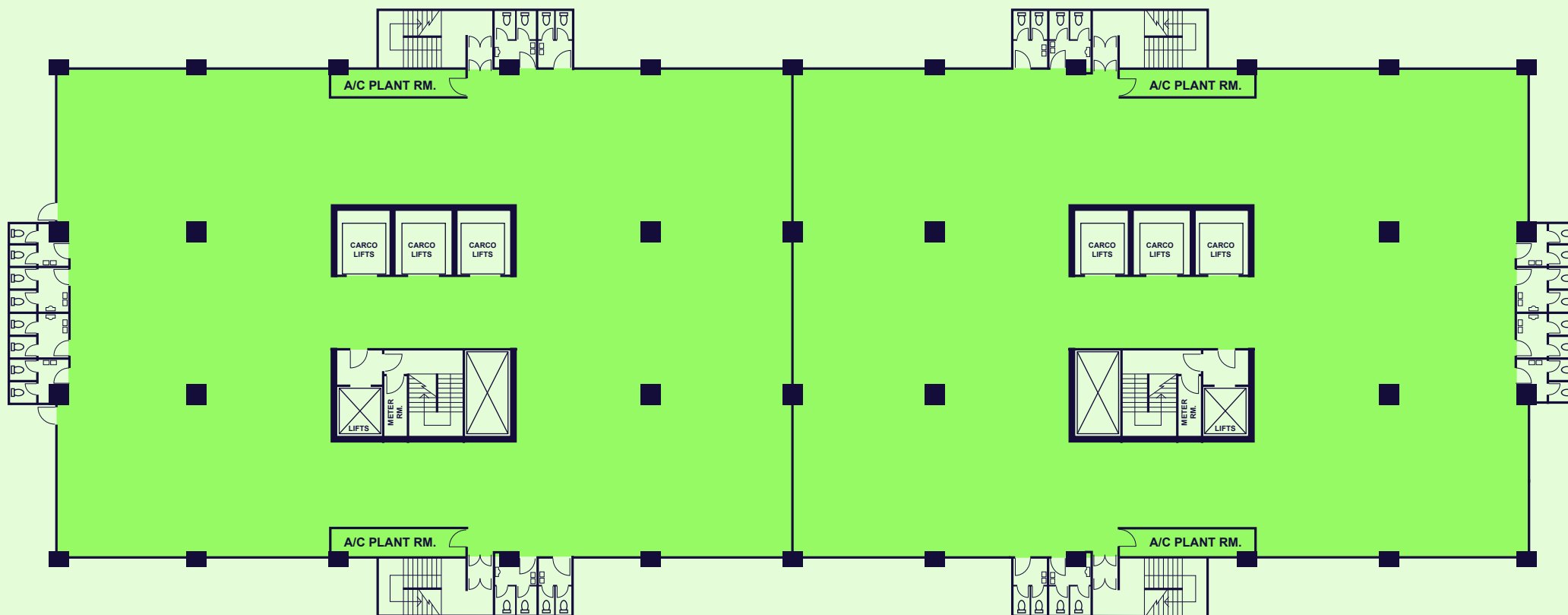
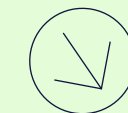

Castle Peak Road



Disclaimer 免責聲明:

This document has been prepared by Goodman Asia Limited for general information purposes only. Whilst every care has been taken in relation to its accuracy, no warranty of accuracy is given or implied. Interested parties should obtain independent advice before making any decisions about the property referred to in this document. Images contained in this document have been used to enable the visualisation of the building concepts only.

本文件由Goodman Asia Limited (“Goodman”)製作，內容僅供作一般參考之用。Goodman已竭力確保文件所提供之資料準確，但對於資料之準確度，Goodman並不作任何承諾或保證。對本文件所提及之物業有興趣之人士，須自行尋求獨立專業人士提供意見。而本文件所刊載之圖片，只供作瞭解物業概念之用。

Leasing hotline
租務熱線

2249 3188
leasing.hk@goodman.com

hk.goodman.com

